

New Development

1,500 – 3,100 sf

Medical / Retail



## MEDICAL / RETAIL SPACE IN SPRUCE GROVE FOR LEASE

1 Ballpark Way  
Spruce Grove

- » Direct exposure on Highway 16A.
- » Part of major new development east of Pioneer Road, which will include Myshak Metro Ballpark.



FOR MORE  
INFORMATION OR  
TO VIEW, PLEASE  
CONTACT:

**Aline Schoepp**, ASSOCIATE

C: 780-910-6893

O: 780-463-3332

aschoepp@barclaystreet.com



**TCN**  
WORLDWIDE  
REAL ESTATE SERVICES

LOCAL  
EXPERTISE  
MATTERS









## LEASE INFORMATION



Daycare and a liquor store already exist on site.  
No additional daycare or a liquor store are available at this location.

ADDRESS: 1 Ballpark Way, Spruce Grove

LEGAL: Plan 2422002; Block 2; Lot 3A;

ZONING: C2 (Vehicle Oriented Commercial)

AVAILABLE FOR LEASE:

BUILDING **1**: 1,500 – 3,100 sq. ft.

- Area is demisable to 1,500 sf and 1,600 sf and is negotiable

AVAILABILITY:

Scheduled for fixturing Q1 2026

PARKING:

Total 53 total parking stalls on site (shared between buildings **1** and **2**).

OP. COSTS: TBD

NET RENT: Market

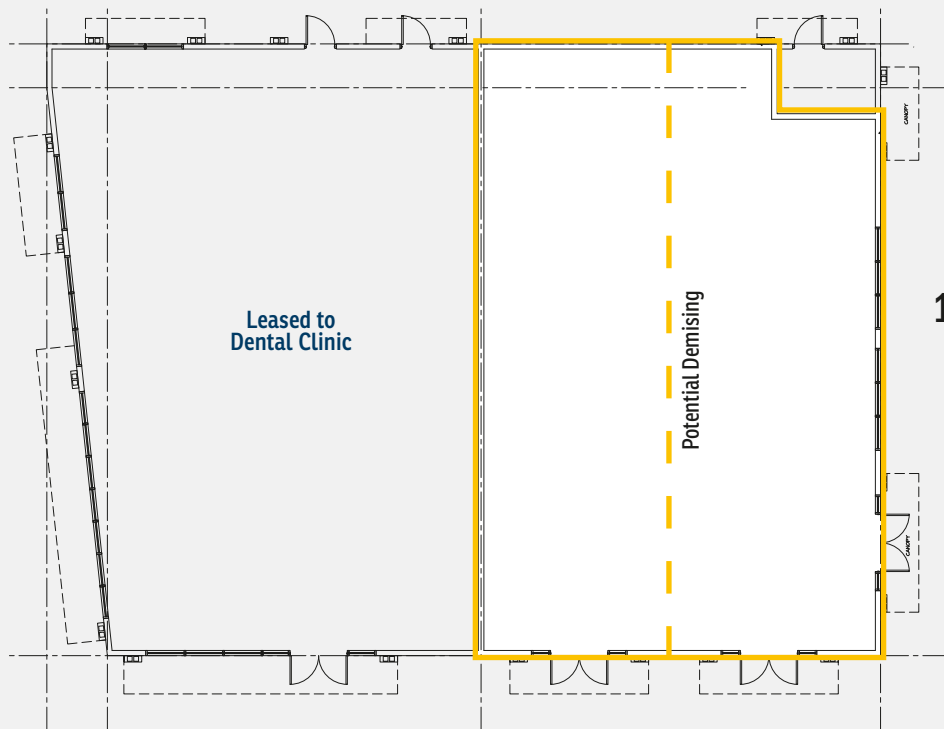

Available  
**1,500 – 3,100** SQ.FT.

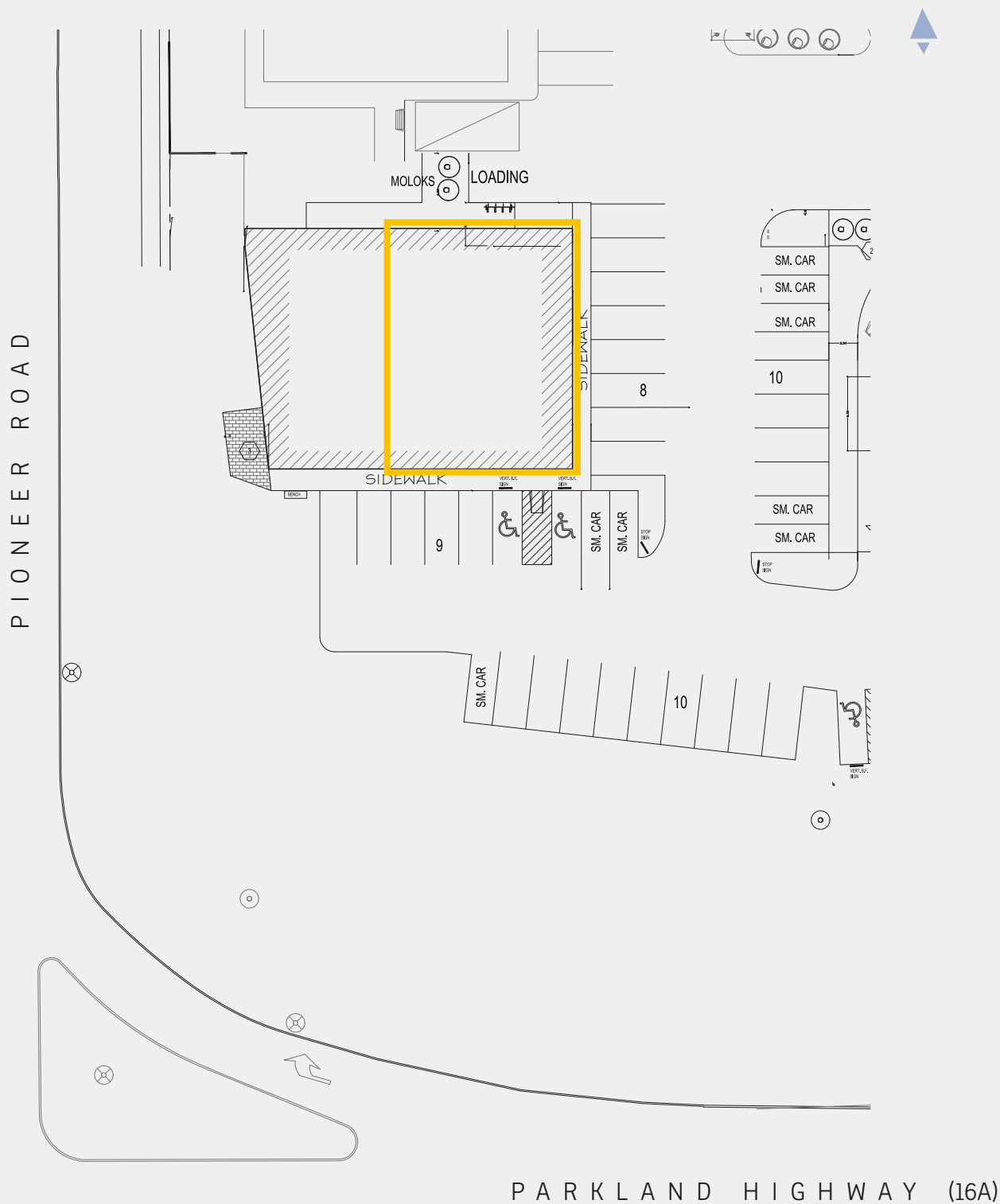

The information contained herein has been gathered from sources deemed reliable, but is not warranted as such and does not form any part of any future contract. This offering may be altered or withdrawn at any time without notice.

Copyright © 2025 Barclay Street Real Estate Ltd. All rights reserved.



LOCAL EXPERTISE MATTERS