



RETAIL SPACE FOR LEASE

Elbow Park Plaza

8408 Elbow Drive SW, Calgary

1,930.5 sf Unit 101

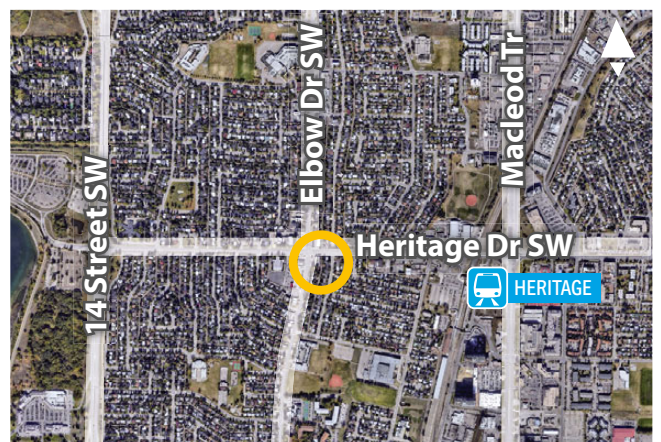

FOR MORE
INFORMATION OR
TO VIEW, PLEASE
CONTACT:

Andrew Sherbut, VICE PRESIDENT

C: 403-607-1819

O: 403-290-0178

asherbut@barclaystreet.com



CELEBRATING

50 YEARS

1973-2023



UNIT 101 **1,930.5** SQ.FT.

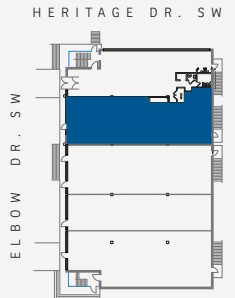
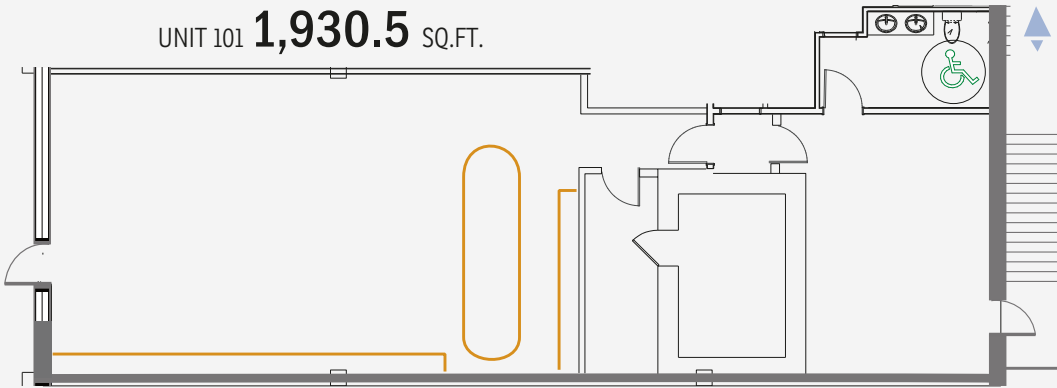

Floorplan to be verified. Subject to change.

- » Located within high-profile, densely populated area.
- » Excellent exposure to high traffic on Elbow Drive SW and Heritage Drive SW.
- » In proximity to Heritage LRT Station.
- » Heritage Drive SW connects property to Macleod Tr., 14 St. SW and Deerfoot Tr.

LEASE INFORMATION

ADDRESS: 8408 Elbow Drive SW, Calgary

COMMUNITY: Haysboro

AVAILABLE FOR LEASE:
1,930.5 sq. ft. – Unit 101 (main floor)

PARKING:
23 u/g stalls and 10 surface

OP. COSTS AND TAXES:
\$17.25 per sq. ft. (est.)

NET RENT: Market

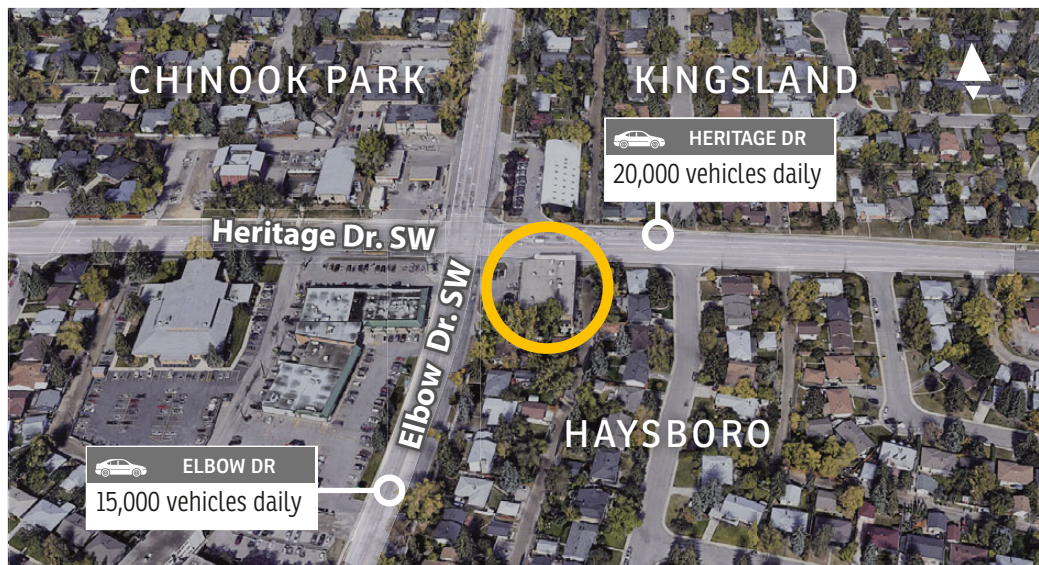

Population
30,204



Average
Household Income
\$120,243



Median Age
42



Current Consumption per Person



\$13,577
FOOD



\$5,278
HEALTH CARE



\$5,072
RECREATION



\$1,939
PERSONAL CARE



\$4,208
LIQUOR/TOBACCO

2 km radius. Source: Statistics Canada

The information contained herein has been gathered from sources deemed reliable, but is not warranted as such and does not form any part of any future contract. This offering may be altered or withdrawn at any time without notice.

Copyright © 2024 Barclay Street Real Estate Ltd. All rights reserved.

